



# **Spirituality and Religion as Universal Aspects of Human Functioning**

*Department of Pastoral Counseling*

*Loyola College in Maryland*

**&**

*Division 36 (Psychology of Religion) of the  
American Psychological Association*

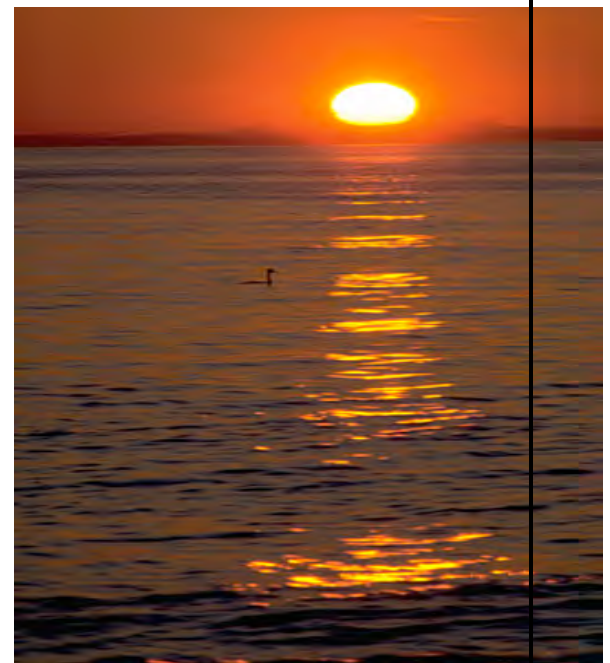

**2<sup>nd</sup> Annual Mid Winter Research Conference  
on Religion and Spirituality**

**March 19 and 20, 2004  
Graduate Center – Columbia Campus  
Loyola College in Maryland**

# Mid Winter Meeting Summary of Events

## Opening Ceremony - Friday 10:30-11:00

### *Guest Speakers:*

*Amanda Thomas, Ph.D.* – Associate Dean for Graduate Programs, Loyola College in Maryland

*Robert Emmons, Ph.D.* – President, Division 36, University of California at Davis

*Ralph L. Piedmont, Ph.D.* – Department Of Pastoral Counseling, Loyola College in Maryland

## Invited Speakers

- Richard M. Lerner, Ph.D. – (Tufts University) ***On Making Humans Human: Spirituality and the Promotion of Positive Youth Development***, Friday, 1:30-2:20pm - Room 230
- Jan Sinnott, Ph.D. – (Towson University) ***Feeling Connected, Spirituality, and Adult Development: A New Theory of their Interrelationships***, Friday, 2:30-3:20pm – Room 230
- Barbara L. Fredrickson, Ph.D. - (University of Michigan) ***Tapping into Universals: The Importance of Positive Emotions within Spiritual and Religious Experiences***, Friday, 3:30-4:20pm – Room 230
- P. Scott Richards, Ph.D. – (Brigham Young University) ***Spiritual Identity Development: Implications for Personality Change, Healing, and Psychotherapy***, Saturday, 10:00-10:50am – Room 230
- Justin L. Barrett, Ph.D. – (Private Practice) ***Why Would Anyone Believe in God? An Introduction to the Cognitive Science of Religion***, Saturday, 3:00-3:50am – Room 230
- Michael E. McCullough, Ph.D. – (University of Miami in Coral Gables) ***Moving Pictures: Longitudinal Studies of Religious Development and the Links of Religion to Health and Well-Being***, Saturday, 4:00-4:50 pm – Room, 230

## Focus Papers

- Robert A. Emmons, Ph.D. – (University of California at Davis) ***Sacred Purposes: What They Are and Why They Matter***, Saturday, 1:00-1:50 pm – Room 260
- Ralph L. Piedmont, Ph.D. – (Loyola College in Maryland) ***Doing Cross-Cultural Research with Spirituality: The Spiritual Transcendence Scale in the Philippines***, Saturday, 2:00-2:50 pm –Room 260

## Social Events

- Friday 5:00 - 5:30 – Social Hour – All are invited to attend
- Friday 5:30-9:00 – Buffet Dinner - \$25.00 charge

**Division 36 Executive Committee Meeting:** Saturday, 11:00 – 12:30 pm Room 280.

**Schedule of Events**

# Friday

	<b>Big Room Room 230/210</b>	<b>Room 260 Saturday Only</b>	<b>Room 262</b>	<b>Room 259</b>	<b>Room 261</b>	<b>Room 270</b>	<b>Room 272</b>
<b>10:30</b>	Opening Ceremony	no events	no events	no events	no events	no events	no events
<b>11-11:20</b>	Symposium - Supervising and Teaching the Integration of Psychology and Spirituality - Gillespie			Symposium - Must Religion Be Supernatural? - Mirman	Paper - Adolescence and Spirituality - Mislowack, Cecero, Glatthorn, Yanni	Paper - Theistic Perspectives in the Scientific Study of Spirituality- Jensen, Harris, Helminiak, Hathaway	
<b>11:30-11:50</b>							
<b>12:00-12:20</b>							
<b>12:30-12:50</b>							
<b>1:00-1:20</b>							
<b>1:30-2:20</b>	R. Lerner - Invited Talk		Paper - Spirituality: Psychoanalytic Perspectives - Greer, Marcus	Symposium - "Christ Is" Intervention - Cosenza			
<b>2:30-2:50</b>	Jan Sinnott - Invited Talk			Symposium - Kid, Cults & New Religious Movements - Richmond	Paper - Defining and Marketing of Pastoral Professional Identity - Takooshian, Greenwald	Symposium - African American Church Scale - Martin	Paper - Measuring Spiritual Constructs- Ciarrocchi, Bassett, Scioli, Barclay
<b>3:00-3:20</b>							
<b>3:30-3:50</b>	Barbara Fredrickson - Invited Talk						
<b>4:00-4:20</b>							
<b>4:30-4:50</b>							
<b>5:00-5:30</b>	<b>Social Hour- 3rd Floor Lounge</b>	no events	no events	no events	no events		
<b>5:30-9:30</b>	<b>Buffet - Dinner - Room 360/362</b>	no events	no events	no events	no events		

# Saturday

	<b>Big Room Room 230/210</b>	<b>Room 260 Saturday Only</b>	<b>Room 262</b>	<b>Room 259</b>	<b>Room 261</b>	<b>Room 270</b>	<b>Room 272</b>	<b>Room 330 Saturday Only</b>	<b>Room 280</b>
<b>10-10:50</b>	P Scott Richards - Invited Talk						Paper - Applications of Spiritual Constructs in Clinical Contexts - Sneck, Bellas, Rothschild, Brown	Poster Session I	Division 36 Executive Committee Meeting
<b>10:30-10:50</b>					Paper - Religion and Spirituality and Physical Health - Bremer, Njoku, Turner- Musa, Mueller				
<b>11:00-11:20</b>		Symposium - Clinical Work With God Image - Morin				Paper - Spirituality and Agression - Leach, MacNair			
<b>11:20-11:50</b>									
<b>12-12:20</b>									
<b>12:30-12:50</b>								Poster Session II	
<b>1-1:30</b>		R. Emmons - Focus Paper		Paper - Religious and Spiritual Issues Among Gays and Lesbians - Bourdeau, Daisley			Paper - Religion, Spirituality and Mental Health - Park, Kanter, Murray-Swank, DeSilva		
<b>1:30-1:50</b>									
<b>2:00-2:20</b>		R. Piedmont - Focus Paper	Paper - Jungian Spirituality Workshop - Lee		Symposium - Sexual Abuse - Lemoncelli				
<b>2:30-2:50</b>									
<b>3-3:50</b>	Justin Barrett - Invited Talk			Paper - Psychospiritual Constructs: Application and Evaluation - Herzlik, Howell, Bassett		Symposium - Picking Up the Pieces - Murray- Swank			
<b>4-4:50</b>	Michael McCullough - Invited Talk								

# Guidelines for Obtaining Continuing Education Credit

Continuing Education Credits (CEUs) are available that are recognized by the American Psychological Association. To receive CEU credits for the sessions that a *registered* participant attends, the following guidelines *must* be followed:

- 1.** You must register at the main registration desk.
- 2.** There is a \$25.00 fee charged to cover administrative and material costs. You will receive an official certificate recording your CEU hours.
- 3.** You will receive an attendance form upon which you will need to enter the session number and name of presentation for each session you attend.
- 4.** You must sign in AND out of each session. Sign-in forms will be available in each room for each talk.
- 5.** You will also need to complete an evaluation form for each session you attend.
- 6.** When completed, please drop off your attendance form at the registration desk.
- 7.** Certificates will be mailed to your registered address within 3 weeks.

If you have any questions about this process, please contact a member of the conference team.



# Mid Winter Meeting Program Guide

***DATE: Friday, March 19, 2004***

***Session Name:*** Supervising and Teaching the Integration of  
***Session Number: 101*** Psychology and Spirituality

11:00 AM 12:50 PM Room 230 *Event* *Symposium Reports*

***Title*** ***A Dialogical Model for Pastoral Counseling Integration***  
Thomas Rodgerson, (Loyola College In Maryland)

***Title*** ***Helping Supervisees to Identify and Integrate Spiritual Issues and Metaphors in the Counseling Relationship***  
Geraldine Fialkowski, (Loyola College In Maryland)

***Title*** ***"Sufficient to the Day is the Evil Thereof": Using the Bible in Counseling***  
Joanne Greer, (Loyola College In Maryland)

***Title*** ***Integrating Counseling Theory with Spiritual/Religious Concepts***  
Sharon Cheston, (Loyola College In Maryland)

***Title*** ***Reclaiming Psychology's Soul: A Historical Consideration***  
Kevin Gillespie, (Loyola College In Maryland)

***Session Name:*** Must Religion Be Supernatural? Looking at  
***Session Number: 102*** Religious Beliefs Through a Psychological Lens

11:00 AM 12:50 PM Room 259 *Event* *Symposium Reports*

***Title*** ***A Psychological Re-Examination of Spiritual Experience: Throwing out the Bath Water but Keeping the Baby***  
David Oler Ph. D., (Argosy University)

***Title*** ***Attachment Style, Parental Caregiving and Perceived Image of God***  
M. Chet Mirman Ph. D., (Argosy University)

**DATE: Friday, March 19, 2004**

**Session Name: Adolescence and Spirituality**

**Session Number: 103**

11:00 AM

12:20 PM

Room 261

*Event*

*Paper Session*

**Title**            ***Parental Rejection and Religiosity: Differential Predictors of Mood and Substance Use***

John J. Cecero SJ, Ph. D., Adam L. Fried, (Fordham University)

**Title**            ***Relative Contribution of Various Aspects of Religious Socialization to the Religious Well-Being of Adolescent Girls***

Teresa A. Glatthorn Psy. D., (Holy Family University)

**Title**            ***Religious Intimacy: An Investigation Within Parent-Child Relationships***

Gina M. Yanni Ph. D., (The Kennedy Krieger Institute) Annette Mahoney Ph. D., (Bowling Green State University)

**Title**            ***Teachers' Views on the Ten Commandments in the Classroom***

Alexa Mislowack, Brielle Stark-Adler, Shelby Semino, (Fordham University)

**Session Name: Theistic Perspectives in the Scientific Study of**

**Session Number: 104    Spirituality**

11:30 AM

12:50 PM

Room 270

*Event*

*Paper Session*

**Title**            ***A Human Science Approach to the Study of Spirituality: Thoughts From the Christian East***

Gregory Roy Jensen, (Duquesne University - Dept. of Theology)

**Title**            ***Conceptualizing Religion/Spirituality as an Important Functional Domain: Theoretical Alternatives***

William A. Hathaway Ph. D., (Regent University)

**Title**            ***Grounding the Universality of Spirituality: Appeal to the Human Spirit, Not to Metaphysical Entities***

Daniel A. Helminiak Ph. D., (State University of West Georgia)

**Title**            ***Games and the Sacred: Defining Religious and Spiritual Constructs in Psychology - A Literature***

Kevin A. Harris, (Ball State University)

**DATE: Friday, March 19, 2004**

**Session Name:** Invited Address - Richard Lerner

**Session Number:** 105

1:30 PM      2:20 PM      Room 230      *Event*      *Invited Address*

**Title**      ***On Making Humans Human: Spirituality and the Promotion of Positive Youth Development***

Richard M. Lerner Ph.D., (Tufts University)

**Session Name:** Crisis Interventions/ "Christ-Is" Intervention in an Inner City Multi-Cultural Harlem Christian Academy

**Session Number:** 106

1:30 PM      2:20 PM      Room 259      *Event*      *Symposium Reports*

**Title**      ***"Christ Is" Intervention - Characteristics of Learning and Behavior Disorders***

Rev Harriet Rodriguez, (Mount Pleasant Community Church)

**Title**      ***"Christ Is" Intervention: The integration of Christian Values with Crisis Intervention***

Pastor Charles Eatman, (Mt. Pleasant Community Church)

**Title**      ***Crisis Intervention /"Christ Is" Intervention: Fitness Training in Spiritual Valor***

Anthony B Cosenza Ph. D., (The College of New Rochelle)

**Session Name:** Spirituality, A Psychoanalytic Perspective

**Session Number:** 107

1:30 PM      2:20 PM      Room 262      *Event*      *Paper Session*

**Title**      ***A Qualitative Narrative Analysis of Psychodynamic Themes in the Catholic Eucharistic Ritual***

Joanne Greer, (Loyola College In Maryland)

**Title**      ***The Religious Believer, the Psychoanalytic Intellectual, And the Challenge of Sustaining the Self in the Concentration Camps***

Paul Marcus Ph. D., (National Psychological Assoc. for Psychoanalysis)



**DATE: Friday, March 19, 2004**

**Session Name: Invited Address - Jan Sinnott**

**Session Number: 108**

2:30 PM 3:20 PM Room 230 *Event Invited Address*

**Title** *Feeling Connected, Spirituality, and Adult Development: A New Theory of Their Interrelationships*

Jan Sinnott Ph.D., (Towson University)

**Session Name: Defining and Marketing a Pastoral Professional**

**Session Number: 109 Identity**

2:30 PM 3:20 PM Room 261 *Event Paper Session*

**Title** *In the Eyes of the Beholder: The Obstacles to the Marketing of Pastoral Counseling*

Carole A. Greenwald Ph. D., (Loyola College in Maryland)

**Title** *The Publication of Catholics in Psychology (1954) and the Origins of APA Division 36*

Harold Takooshian Ph. D., John J. Cecero SJ, Ph. D., (Fordham University)

**Session Name: Measuring Spiritual Constructs**

**Session Number: 110**

2:30 PM 3:50 PM Room 272 *Event Paper Session*

**Title** *Faith, Hope and Optimism as Predictors of Happiness: And the Greatest of These is Hope*

Joe Ciarrocchi Ph.D., Erin Deneke MS, (Loyola College In Maryland)

**Title** *One Effort to Measure Implicit Attitudes Toward Spirituality and Religion*

Jaime Barclay, Colleen Powers, Abigail Smith, Jacquelyn Thrower, Meredith Tindall, Karrie Tiuch, John Monroe, Rodney L. Bassett Ph.D., (Roberts Wesleyan College)

**Title** *The Comprehensive Hope Scale: A Spiritual Sensitive Tool*

Anthony Scioli, Mike Ricci, (Keene State College) Felice Scioli, (Hobart College)

**Title** *The Curious Virtue of Humility: One Effort to Measure Humility*

Jennifer H. Staskiewicz, Jill Breon-Milliman, Marleah Bouchard, Julie Schoonover, Sheri Bryant, Kara Trosinski,, Rodney L. Bassett Ph.D., (Roberts Wesleyan College)

**DATE: Friday, March 19, 2004**

**Session Name: Kids, Cults & New Religious Movements**

**Session Number: 111**

3:00 PM 4:50 PM Room 259 *Event Symposium*

**Title** *Adolescents Reacting to Trauma: Spirituality and Peacefulness Measures*

Carole A. Rayburn Ph. D., M. Div., (Private Practice)

**Title** *The Vulnerable Minds: Kids and Cults, as Distinguished from Healthy Religious Beliefs and Spirituality*

Anita O. Solomon Ph. D., ABPP,

**Title** *What Happens When Adolescent Spirituality Goes Awry*

Lee Richmond Ph. D., (Loyola College in Maryland)

**Session Name: Invited Address - Barbara Fredrickson**

**Session Number: 112**

3:30 PM 4:20 PM Room 230 *Event Invited Address*

**Title** *Tapping into Universals: The Importance of Positive Emotions within Spiritual and Religious Experiences*

Barbara L. Fredrickson Ph. D., (University of Michigan)

**Session Name: The African American Church Scale: A Tool for Understanding and Exploring the African American Faith Community**

**Session Number: 113**

3:30 PM 4:50 PM Room 270 *Event Symposium*

**Title** *The African American Church Scale: A Tool for Understanding and Exploring Theological Orientations Within African American Faith Communities*

Pamela P. Martin Ph.D., (North Carolina State University)

**Title** *Theological Orientation: A Socialization Agent in African American Faith Communities*

Sheretta T. Butler, (Wayne State University)

**Title** *The African American Church and Parents: Shaping Adolescents' Racial Identity Attitudes*

Erin Banks, (North Carolina State University)

**DATE: *Saturday, March 20, 2004***

***Session Name:* Invited Address - P. Scott Richards**

***Session Number:* 114**

10:00 AM 10:50 AM Room 230 *Event Invited Address*

***Title*** ***Spiritual Identity Development: Implications for Personality Change, Healing and Psychotherapy***

P. Scott Richards Ph.D., (Brigham Young University)

***Session Name:* Applications of Spiritual Constructs in Clinical**

***Session Number:* 115 Contexts**

10:00 AM 11:20 AM Room 272 *Event Paper Session*

***Title*** ***A Psycho-Spiritual Approach for Dealing with the "Hard" Emotions***

William Sneek SJ, (Jesuit Center for Spiritual Growth)

***Title*** ***Hearts Ease: A Hope-Based Treatment Program for Adults with Depression***

Diane S. Bellas MA, D.Min. (Private Practice )

***Title*** ***Sacred Gifts: A Spiritually Oriented Group Intervention for Elders***

Peter Rothschild, Brian McCorkle, Nancy Devor, Lori Brown-Frankel (Boston University - Danielson Institute)  
Ken Pargament, (Bowling Green State University)

***Title*** ***Therapists Perspectives on Religious and/or Spiritual Issues in Psychotherapy: Implications for Practice and Future Research***

Andrea M Brown M. Ed, (Arizona State University)

***Session Name:* Religion, Spirituality and Physical Health**

***Session Number:* 116**

10:30 AM 11:50 AM Room 261 *Event Paper Session*

***Title*** ***Health as a Universal Aspect of Human Experience: Role of Religion and Spirituality***

William H. Mueller Ph. D., (University of Texas, Houston)

***Title*** ***Religion and Quality of Life with Amyotrophic Lateral Sclerosis***

Barbara A. Bremer Ph.D., Ann-Louise Simone, (Penn State Harrisburg) Susan Walsh RN, MSN, CS, (The Amyotrophic Lateral Sclerosis Association) Zachary Simmons MD, (Penn State College of Medicine)  
Stephanie H. Felgoise Ph.D., (Phil. College of Osteopathic Medicine)

**DATE: Saturday, March 20, 2004**

**Session Name: Religion, Spirituality and Physical Health (Continued)**

**Session Number: 116**

10:30 AM 11:50 AM Room 261 *Event Paper Session*

**Title** *Spirituality, Social Support, and Health Compromising Behaviors Among Black College Students*

Jocelyn Turner-Musa Ph. D., LaShaunna Lipscomb, (Morgan State University)

**Title** *The Relationship Between Turning to Religion and Health Outcomes Among Individuals with Unexplained Chronic Fatigue*

Mary Gloria Njoku DDL, Leonard A Jason Ph. D., (DePaul University Chicago)

**Session Name: Clinical Work with Clients' of God Image in Counseling**

**Session Number: 117**

11:00 AM 11:50 AM Room 260 *Event Symposium*

**Title** *Clinical Work with Clients' of God Image in Counseling - A Case Study*

Marie-Line Morin Ph. D., (Universite de Sherbrooke)

**Title** *Clinical Work with Clients' of God Image in Counseling - Tools for Addressing clients' God Image*

Richard T. Lawrence Ph. D., (Saint Vincent de Paul Church)

**Session Name: Spirituality and Aggression**

**Session Number: 118**

11:00 AM 11:50 AM Room 270 *Event Paper Session*

**Title** *How Long Does Church Last? An Aggression Paradigm Study*

Mark Leach Ph. D., Lea Eubanks, Mitchell Berman Ph.D., Dana Powell, (The University of Southern Mississippi)

**Title** *The Dove Needs Both Wings to Fly: Religious Right & Left Viewpoints on Violence*

Rachel M. MacNair Ph. D., (Institute for Integrated Social Analysis)

# ***DATE: Saturday, March 20, 2004***

***Session Name: Poster Session I***

***Session Number: 119***

11:00 AM

12:30 PM

Room 330

*Event*

*Poster*

***Title***                    ***Affective Reactions to Priming God: Moderating Effects of Image of God***

Howard M. Weiss, Katherine E. Kurek, (Purdue University)

***Title***                    ***Attachment and Religiosity: Examining the Compensational and Revised Correspondence Models Of Adult Religiousness***

Katherine McGuire, Enrico DiTommaso, (University of New Brunswick)

***Title***                    ***Characteristics in Church Attendance and Happiness in Mexico***

Alejandro Tapia-V, Nicole Fuentes, (University of Monterrey)

***Title***                    ***Games and the Sacred, Part II: Defining Religious and Spiritual Constructs in Psychology - Developing a Research Bibliography***

Ranada Bowie, Matt Werner, Erin Gray, Debbie Koliba, Leslie Schellenberg, Kevin A. Harris, (Ball State University)

***Title***                    ***Life Changing Events Among A College-Age Population***

Mark Hartlaub, Jennifer Barnum, (Texas A&M University- Corpus Christi)

***Title***                    ***Religiosity and Depressive Symptoms in Five Adolescent Ethnic Groups***

Thao N. Le, (University of California, Davis) William Tov, (University of Illinois at Urbana-Champaign)

***Title***                    ***The Identification and Assessment of a Female Satan***

Joseph E. G. Williams, (Eastern Illinois University)

***Title***                    ***The Relationship of Spirituality to Adolescent Male Anger and Aggression***

James P Burns, (Harvard Medical School)

***Title***                    ***What Do Clients Want? Assessing Client Spiritual Needs in Counseling - A Literature Review***

Kevin A. Harris, Brooke E. Randolph, Tim D. Gordon, (Ball State University)

**DATE: Saturday, March 20, 2004**

**Session Name: Poster Session II**

**Session Number: 120**

12:30 PM

2:00 PM

Room 330

*Event*

*Poster*

**Title**                    ***A Psychometric Analysis of the Revised Short Form of  
The Spiritual Transcendence Scale***

Annette C. French, Ralph L. Piedmont Ph. D., (Loyola College in Maryland)

**Title**                    ***A Western Spirituality Scale in Indian and Philippine  
Samples: Spirituality as a Universal Aspect of Human  
Experience***

Gabriel Dy-Liacco, Ralph L. Piedmont Ph. D (Loyola College In Maryland) Mark Leach Ph. D., (University of Southern Mississippi)

**Title**                    ***Examining Pastoral Leader Effectiveness***

Judith C. Carter, (Loyola College In Maryland)

**Title**                    ***Measurement of Sexual Orientation Among the  
Religiously and Spiritually Committed***

Linda McCullough, (Loyola College in Maryland)

**Title**                    ***Pickin' and Choosin' Religious Beliefs to Justify Social Attitudes***

Mark Leach Ph. D., Jacob Levy Ph.D. Lisa Denton, Stacy Owens, (University of Southern Mississippi)

**Title**                    ***Predictors of Implicit and Explicit Attitudes Toward  
Christians and Muslims***

Wade C Rowatt Ph. D., Lewis Franklin, Marla Cotton (Baylor University)

**Title**                    ***Spirituality, Life Stress & Subjective Well Being***

Robert J. Cramer, David V. Powers, Joshua M. Grubka, (Loyola College In Maryland)

**Title**                    ***Spirituality, Religiosity and Gender as Predictors of Wellbeing***

Nicholas E. Nnabuaku, Ralph L. Piedmont Ph. D. (Loyola College In Maryland)

# ***DATE: Saturday, March 20, 2004***

***Session Name:*** Religious & Spiritual Issues Among Gays & Lesbians  
***Session Number:*** 121

1:00 PM      1:50 PM      Room 259      *Event*      *Paper Session*

***Title***      ***Coming Out to Parents as Gay or Lesbian: The Relationship of Forgiveness, Religiosity, Social Support and Closeness to Psychopathology***

Winifred Daisley Ph. D.,

***Title***      ***Understanding the Spirituality of Gay Latino Men: A Cross Cultural Validity Study***

Beth Bourdeau, (The Partnership) Oscar Hinojosa, Ernie Perez, (Southern Arizona AIDS Foundation) Kwang-lee Chu, (The Partnership)

***Session Name:*** Presidential Address - Robert Emmons  
***Session Number:*** 122

1:00 PM      1:50 PM      Room 260      *Event*      *Invited Address*

***Title***      ***Sacred Purposes: What They Are and Why They Matter***

Robert A. Emmons, (University of California - Davis)

***Session Name:*** Religion, Spirituality and Mental Health  
***Session Number:*** 123

1:00 PM      2:20 PM      Room 272      *Event*      *Paper Session*

***Title***      ***Beliefs in a Deity as Predictors of Mental Health: A Functional Perspective***

Angela DeSilva, (Boston College) Kenneth G. DeBono, (Union College)

***Title***      ***Outcomes of Spiritual Confession: An Experimental Study***

Aaron Murray-Swank Ph. D., (VA Maryland Healthcare Systems) Ken Pargament, (Bowling Green State University)

***Title***      ***Religiousness and the Meaning of Stressful Life Encounters***

Crystal L Park Ph.D., (University of Connecticut)

***Title***      ***Survey of Shared Spiritual Needs Among World Religions: Foundational Support in the Development Of a New Definition for Spiritual Health***

Janet Kanter Ph.D.; MPH; BSN, ()

**DATE: *Saturday, March 20, 2004***

***Session Name:* Focus Paper - Ralph Piedmont**

***Session Number:* 124**

2:00 PM      2:50 PM      Room 260      *Event*      *Invited Address*

***Title***      ***Doing Cross-Cultural Research with Spirituality: The Spiritual Transcendence Scale in the Philippines***

Ralph L. Piedmont Ph. D., (Loyola College in Maryland)

***Session Name:* A Jungian Spirituality Workshop**

***Session Number:* 125**

2:00 PM      2:50 PM      Room 262      *Event*      *Paper Session*

***Title***      ***A Jungian Spirituality Workshop***

Renee Raimondi Lee,

***Session Name:* Sexual Abuse: Parasite of the Heart and Soul**

***Session Number:* 126**

2:30 PM      3:50 PM      Room 261      *Event*      *Symposium Reports*

***Title***      ***Etiology and Development of the Parasite Model of Abuse***

John Lemoncelli Ed. D., Susan M. Thompson, (Marywood University)

***Title***      ***Psychospiritual Dimensions of the Parasite Model of Abuse***

John Lemoncelli Ed. D., (Marywood University)

***Title***      ***Treatment Techniques Within the Parasite Model of Abuse***

John Lemoncelli Ed. D., Meaghan Broderick, (Marywood University)

***Session Name:* Invited Address - Justin Barrett**

***Session Number:* 127**

3:00 PM      3:50 PM      Room 230      *Event*      *Invited Address*

***Title***      ***Why Would Anyone Believe in God? An Introduction to the Cognitive Science of Religion***

Justin Barrett



**DATE: Saturday, March 20, 2004**

**Session Name: Psychospiritual Constructs: Application & Evaluation**  
**Session Number: 128**

3:00 PM 4:50 PM Room 259 *Event Paper Session*

**Title** *Comparing Measures of Spirituality*  
Karen Herdzik , (University at Buffalo )

**Title** *Students Perceptions of Jesus' Personality as Assessed by Jungian-Type Inventories*  
Susan Howell , (Campbellsville University )

**Title** *Walking Down the Sunny Side of the Street: Optimism For the Present and the Future*  
Rodney L. Bassett Ph.D., Irene Garrick , Donna Birrittella , Matt Olmstead , (Roberts Wesleyan College )

**Session Name: Picking Up the Pieces - The Integration of Spirituality and Psychology in Trauma Recovery**  
**Session Number: 129**

3:00 PM 4:50 PM Room 270 *Event Symposium Reports*

**Title** *Friends or Foes? A Research Overview on the Relationship between Spirituality and Sexual Abuse*  
Nichole Murray-Swank Ph. D., (Loyola College In Maryland )

**Title** *Sexual Abuse: Facilitating Effective Reconstruction of Sacred Meaning*  
Nichole Murray-Swank Ph. D., (Loyola College In Maryland )

**Title** *Trauma as a Limit-Situation for psychology and spirituality: Hopeful points of convergence from two wisdom sources*  
Joe Ciarrocchi Ph.D., (Loyola College In Maryland)

**Title** *The Spiritual Realm of Trauma: Religious Coping & Abuse*  
Anne Grace M.S., Ralph L. Piedmont Ph. D., (Loyola College in Maryland)

***DATE: Saturday, March 20, 2004***

***Session Name:***

**Invited Address - Michael McCullough**

***Session Number: 130***

4:00 PM

4:50 PM

Room 230

*Event*

*Invited Address*

***Title***

***Moving Pictures: Longitudinal Studies of Religious Development and the Links of Religion to Health and Well Being***

Michael McCullough Ph.D. (University of Miami at Coral Gables)



## Speakers' Biographies

**Justin Barrett:** After completing his Ph.D. in experimental psychology at Cornell University, Justin served on the psychology faculties of Calvin College and the University of Michigan and as a research fellow of the Institute for Social Research. He served as the associate director of the International Culture and Cognition Consortium and was a founding editor of the *Journal of Cognition and Culture*. His cross-cultural, developmental, and experimental research on religious concepts has appeared in numerous books and scholarly journals. His authored book, "*Why would anyone believe in God?*" (published by Ala Mira Press) will appear in May, 2004. Dr. Barrett currently provides part-time consulting on numerous research and evaluation projects for academic and nonprofit groups; but his full time occupation is stay-at-home dad, home schooling his ten-year-old son and eight-year-old daughter.

**Robert A. Emmons:** Robert A. Emmons, Ph.D. is Professor of Psychology at the University of California, Davis. He received his Ph.D. degree in Personality and Social Ecology from the University of Illinois at Urbana-Champaign. He is the author of nearly 70 original publications in peer-reviewed journals or chapters in edited volumes, including the acclaimed book *The Psychology of Ultimate Concerns: Motivation and Spirituality in Personality* (Guilford Press). His research focuses on personal goals, spirituality, the psychology of gratitude and thankfulness, and subjective well-being. He has received research funding from the National Institute of Mental Health, the John M. Templeton Foundation, and the National Institute for Disability Research and Rehabilitation.

**Barbara L. Fredrickson:** Received her Ph.D. from Stanford University in 1990. She completed a postdoctoral fellowship on the psychophysiology of emotions at UC Berkeley. She is currently an Associate Professor of Psychology and Faculty Associate at the Research Center for Group Dynamics at the University of Michigan. Her research centers on emotions, especially positive emotions and emotional resilience. Her research is supported by grants from the NUMH and the University of Michigan. Her research and teaching have been recognized with numerous awards, including, in 2000, the largest prize awarded in psychology, the Templeton Positive Psychology Prize.

**Richard M. Lerner:** He is the Bergstrom Chair in Applied Developmental Science and the Director of the Applied Developmental Science Institute in the Eliot-Pearson Department of Child Development at Tufts University. A developmental psychologist, Lerner received a Ph.D. in 1971 from the City University of New York. He has been a fellow at the Center for Advanced Study in the Behavioral Sciences and is a fellow of the American Association for the advancement of Science, the American Psychological Association, and the American Psychological Society. Prior to joining Tufts University, he was on the faculty and held administrative posts at Michigan State University, Pennsylvania State University, and Boston College, where he was the Anita L. Brennan Professor of Education and the Director of the Center for Child, Family, and Community Partnerships. During the 1994-95 academic year, Lerner held the Tyner Eminent Scholar Chair in the Human Sciences at Florida State University. Lerner is the author or editor of 56 books and more than 385 scholarly articles and chapters. He edited Volume 1, "Theoretical Models of Human Development," for the fifth edition of the *Handbook of Child Psychology* (1998), edited (with Francine Jacobs and Donald Wertlieb) the four volume *Handbook of Applied Developmental Science* (2003), edited (with Laurence Steinberg) the second edition of the *Handbook of Adolescent Psychology* (2004), and is editing (with William Damon) the forthcoming sixth edition of the *Handbook of Child Psychology*. He is the founding editor of the *Journal of Research on Adolescence* and of *Applied Developmental Science* (2003). He is known for his work on the relations between life-span human development and contextual or ecological change. He has done foundational studies of the mutually influential relations between adolescents and their peer, family, school, and community contexts, and is a leader in the study of public policies and community-based programs aimed at the promotion of positive youth development.

## Speakers' Biographies (Continued)

**Michael E. McCullough:** Dr. McCullough is an associate professor in the Department of Psychology and the Department of Religious Studies at the University of Miami in Coral Gables, Florida. He is a previous recipient of the Margaret Gorman Early Career Award from Division 36 and received a John Templeton Foundation/American Psychological Association Award for Research in Positive Psychology. Dr. McCullough's current research and scholarship focus on: (a) the development of religiousness and spirituality across the life course; (b) the social and psychological foundations for traditional virtues such as forgiveness and gratitude; and, (c) the associations of the above mentioned concepts with physical health, psychological well-being, and social relationships.

**Ralph L. Piedmont:** is a professor in the Department of Pastoral Counseling at Loyola College in Maryland. Dr. Piedmont received his Ph.D. in personality psychology from Boston University following which he received a two-year postdoctoral fellowship at the National Institute of Aging where he worked with Paul Costa Jr. and Robert McCrae. The focus of his work was on the five-factor model of personality and its utility as a predictive model of personality's impact on mental and physical health outcomes. Building on this foundation, Dr. Piedmont has developed a motivational measure of spirituality called Spiritual Transcendence. His research with this instrument has shown its predictive value in nonclinical, substance abuse, medical, and cross-cultural samples. He is well published in the areas of both personality and psychology of religion. Currently he is co-editor (along with David Moberg) of *Research in the Social Scientific Study of Religion* and sits on the editorial boards of a number of journals in both psychology and counseling, including *Counseling & Values*, *Journal of Personality Assessment*, and *Assessment*.

**P. Scott Richards:** Received his Ph.D. in counseling psychology in 1988 from the University of Minnesota. He is a professor in the Department of Counseling Psychology and Special Education at Brigham Young University. Dr. Richards is co-author and co-editor of several books that have been published by the American Psychological Association (APA) including *A Spiritual Strategy for Counseling and Psychotherapy* (1997), *Handbook of Psychotherapy and Religious Diversity* (2000), and *Casebook for a Spiritual Strategy in Counseling and Psychotherapy* (2004). In 1999, he was awarded the William C. Bier Award from Division 36 (Psychology of Religion) of APA. He is currently President-elect of Division 36. Dr. Richards is a licensed psychologist and maintains a small private psychotherapy practice at the Center for Change in Orem, Utah.

**Jan Sinnott:** Is professor of psychology in the Psychology Department at Towson University, Baltimore, MD ([jsinnott@towson.edu](mailto:jsinnott@towson.edu)). She received her Masters and Doctorate from The Catholic University of America, Washington, DC, specializing in positive cognitive development during adulthood and aging. After experience as a postdoctoral fellow and a Guest Scientist at the National Institute on Aging she developed her theory of Complex Post-formal Thought, supporting it with more than 20 years of research and applications in all the individual and personal domains of behavior in which complex problems of living can be found. Her numerous publications include her book, *The Development of Logic in Adulthood: Postformal Thought and its Applications* (Plenum). Three areas of life involving complex thinking are the university as a teacher of adults, spiritual development, and felt connection or "community" and development during adulthood. These are her current areas of research and writing. Her private practice has a humanistic/transpersonal orientation and is located in Towson.



# Index of Presenters

Banks	Erin	113	Fuentes	Nicole	119
Barclay	Jaime	110	Garrick	Irene	128
Barnum	Jennifer	119	Gillespie	Kevin	101
Barrett	Justin	127	Glatthorn	Teresa A.	103
Bassett	Rodney L.	110, 128	Gordon	Tim D.	119
Bellas	Diane S.	115	Grace	Anne	129
Berman	Mitchell	118	Gray	Erin	119
Birrittella	Donna	128	Greenwald	Carole A.	109
Bouchard	Marleah	110	Greer	Joanne	101, 107
Bourdeau	Beth	121	Grubka	Joshua M.	120
Bowie	Ranada	119	Harris	Kevin A.	119, 104
Bremer	Barbara A.	116	Hartlaub	Mark	119
Breon-Milliman	Jill	110	Hathaway	William A.	104
Broderick	Meaghan	126	Helminiak	Daniel A.	104
Brown	Andrea M	115	Herdzik	Karen	128
Brown-Frankel	Lori	115	Hinojosa	Oscar	121
Bryant	Sheri	110	Howell	Susan	128
Burns	James P	119	Jason	Leonard A	116
Butler	Sheretta T.	113	Jensen	Gregory Roy	104
Carter	Judith C.	120	Kanter	Janet	123
Cecero	John J.	103, 109	Koliba	Debbie	119
Cheston	Sharon	101	Kurek	Katherine E.	119
Chu	Kwang-lee	121	Lawrence	Richard T.	117
Ciarrocchi	Joe	110, 129	Le	Thao N.	119
Copeland-Linder	Nikeea	113	Leach	Mark	120, 118
Cosenza	Anthony B	106	Lee	Renee Raimondi	125
Cotton	Marla	120	Lemoncelli	John	126
Cramer	Robert J.	120	Lerner	Richard M.	105
Daisley	Winifred	121	Levy	Jacob	120
DeBono	Kenneth G.	123	Lipscomb	LaShaunna	116
Deneke	Erin	110	MacNair	Rachel M.	118
Denton	Lisa	120	Mahoney	Annette	103
DeSilva	Angela	123	Marcus	Paul	107
Devor	Nancy	115	Martin	Pamela P.	113
DiTommaso	Enrico	119	McCorkle	Brian	115
Dy-Liacco	Gabriel	120	McCullough	Michael	130
Eatman	Charles	106	McCullough	Linda	120
Emmons	Robert A.	122	McGuire	Katherine	119
Eubanks	Lea	118	Mirman	M. Chet	102
Felgoise	Stephanie H.	116	Mislowack	Alexa	103
Fialkowski	Geraldine	101	Monroe	John	110
Franklin	Lewis	120	Morin	Marie-Line	117
Fredrickson	Barbara L.	112	Mueller	William H.	116
French	Annette C.	120	Muller	Lynne	111
Fried	Adam L.	103	Murray-Swank	Nichole	12

# Index of Presenters

## (Continued)

Murray-Swank	Aaron	123	Werner	Matt	119
Njoku	Mary Gloria	116	Williams	Joseph E. G.	119
Nnabuaku	Nicholas E.	120	Yanni	Gina M.	103
Oler	David	102			
Olmstead	Matt	128			
Owens	Stacy	120			
Pargament	Ken	115, 123			
Park	Crystal L.	123			
Perez	Ernie	121			
Piedmont	Ralph L.	129, 124, 120			
Powell	Dana	118			
Powers	David V.	120			
Powers	Colleen	110			
Randolph	Brooke E.	119			
Rayburn	Carole A.	111			
Ricci	Mike	110			
Richards	P. Scott	114			
Richmond	Lee	111			
Rodgerson	Thomas	101			
Rodriguez	Harriet	106			
Rothschild	Peter	115			
Rowatt	Wade C	120			
Schellenberg	Leslie	119			
Schoonover	Julie	110			
Scioli	Anthony	110			
Scioli	Felice	110			
Semino	Shelby	103			
Simmons	Zachary	116			
Simone	Ann-Louise	116			
Sinnott	Jan	108			
Smith	Abigail	110			
Sneck	William	115			
Solomon	Anita O.	111			
Stark-Adler	Brielle	103			
Staskiewicz	Jennifer H.	110			
Takooshian	Harold	109			
Tapia-V	Alejandro	119			
Thompson	Susan M.	126			
Thrower	Jacquelyn	110			
Tindall	Meredith	110			
Tiuch	Karrie	110			
Tov	William	119			
Trosinski	Kara	110			
Turner-Musa	Jocelyn	116			
Walsh	Susan	116			

# Building Floorplans

**Third Floor**

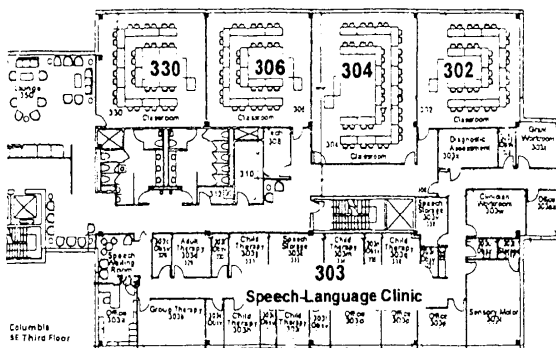
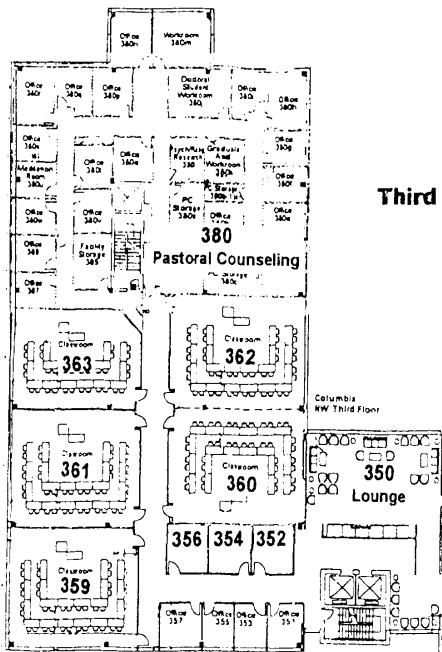

**Second Floor**

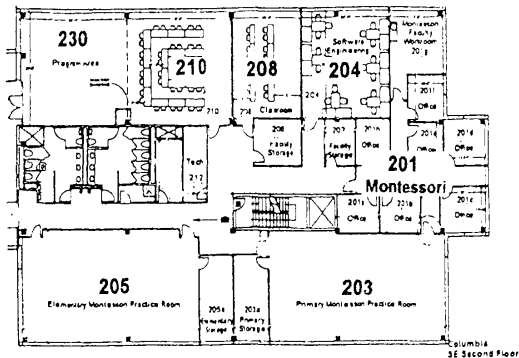
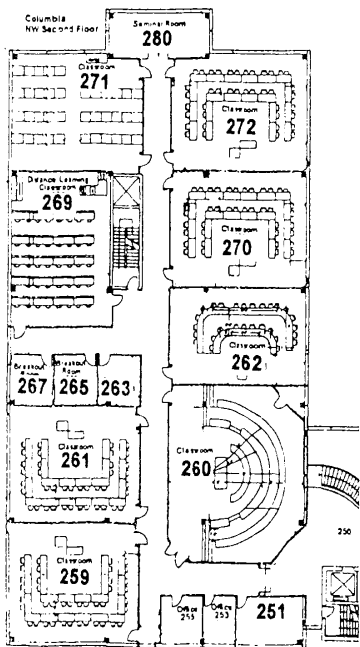

Loyola College Graduate Center  
**COLUMBIA CAMPUS**  
 8890 McGaw Road  
 Columbia, MD 21045

**First Floor**

